

MODEL G-38 TOGGLE COUPLING

The Model G-38 Toggle Coupling is designed for quick connect and disconnect services. The coupling is installed simply by fastening the butterfly nut by hand and disconnected by loosening it. The butterfly nut can be further tightened for secure by the aid of a bar stock. The coupling is rated 20 bar (300 psi) and can be used in a variety of applications with standard rolled or cut grooved pipe.

The Shurjoint Fast-Fit gasket has been designed and engineered for easier and faster installations. The pip-end friendly design eliminates struggling to stretch the gasket over the pipe ends and the Fast-Fit gasket also features Shurjoint's Gap-Seal technology, which seals the gap between the pipe ends and eliminates stagnant water pockets within the gasket cavity.

Fast-Fit gasket: Grade "E" EPDM or Grade "T" Nitrile.
 Surface finish: Black electro-deposition coated.

Always use the factory supplied Shurjoint Fast-Fit gasket.



Fast-Fit Gasket:
 Easy installation with
 a single hand

Pressure-Temperature Rating

Nom. Rating	Working Pressure (STD, Roll-grooved)	Max. Service Temperature
Class 150	300 psi @100°F 20 Bar @38°C	EPDM: 230°F / 110°C Nitrile: 180°F / 82°C

*Working pressure is based on roll- or cut-grooved standard wall carbon steel pipe.

*Proof test pressure: 1.5 times the working pressure, non-shock cold water.

*Burst pressure is engineered minimum 3 times the working pressure

MODEL G-38 TOGGLE COUPLING

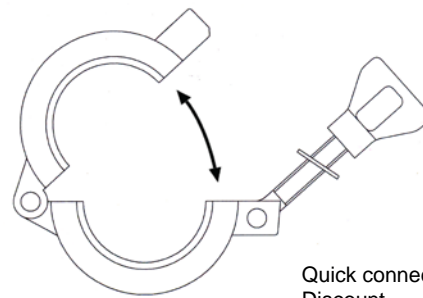
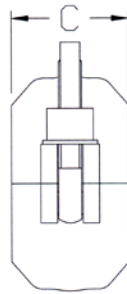
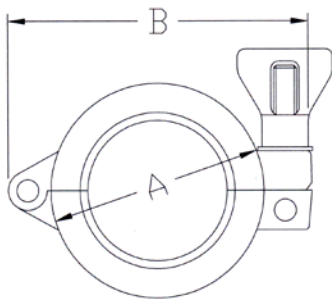

Quick connect and
 Discount

Model G-38 Toggle Coupling									
Nominal Size	Pipe O.D.	Max. Working Pressure	Axial Displacement	Dimensions			Deflection	Approx. Weight	
				A	B	C			
mm	mm	Bar	mm	mm	mm	mm	Degrees*	Kgs	
in	in	PSI	in	in	in	in		Lbs	
40	48.3	20	0 - 1.6	76	111	48	1° - 54'	0.9	
1½	1.900	300	0 - 0.06	3.00	4.36	1.89		1.98	
50	60.3	20	0 - 1.6	84	120	48	1° - 31'	0.9	
2	2.375	300	0 - 0.06	3.30	4.72	1.89		1.98	
80	88.9	20	0 - 1.6	111	162	48	1° - 02'	1.3	
3	3.500	300	0 - 0.06	4.37	6.38	1.89		2.86	
100	114.3	20	0 - 3.2	157	204	51	1° - 36'	2.4	
4	4.500	300	0 - 0.13	6.18	8.03	2.01		5.28	

*Deflection or angular movement is the maximum value that a coupling allows under no internal pressure.

MODEL G-38 – MATERIAL SPECIFICATIONS

- **Housing:**

Ductile Iron to ASTM A536, Gr. 65-45-12, min. tensile strength 448 MPa (65,000 psi).

- **Surface Finish:**

Standard finish is black electro-deposition coated.

- Painted orange or RAL3000 red (Option).
- Epoxy Coatings in RAL3000 red or other colors (Option).

- **Rubber Gasket:**

To assure maximum life for the service intended, proper gasket selection and specification in ordering is essential. Failure to select the proper gasket compound may result in personal injury, property damage, joint leakage or joint failure.

Grade "E" EPDM (Color code: Green stripe) Good for cold & hot water up to +230°F (+110°C). Also good for services for water with acid, water with chlorine, deionized water, seawater and waste water, dilute acids, oil-free air and many chemicals. **Not recommended for petroleum oils, minerals oils, solvents and aromatic hydrocarbons.**

Maximum Temperature Range: -29°F (-34°C) to +230°F (+110°C).

- (Option) **Grade "T" Nitrile** (Color code: Orange stripe) Recommended for petroleum products, air with oil vapors, vegetable and mineral oils within the specified temperature range. Also good for water services under +66°C (+150°F). Temperature range: -29°C to +82°C (-20°F to +180°F). **Do not use for HOT WATER above +66°C (+150°F) or HOT DRY AIR above +60°C (+140°F)**

- Other options: Grade "O" – Fluoroelastomer.
Grade "L" Silicone.
For additional details contact **Shurjoint**.

- **Butterfly Nut:**

Ductile Iron to ASTM A536 Gr. 65-45-12, Min. tensile strength: 448 MPa (65,000 psi).

General Notes:

- Pressure ratings listed are CWP (cold water pressure) or maximum working pressure within the service temperature range of the gasket used in the coupling. For additional information contact **Shurjoint**.
- Maximum working pressures and end loads listed are total of internal and external pressures and loads based on Sch. 40 steel pipe with roll grooves to ANSI/AWWA C606-07 specifications. For information on other pipe schedules contact **Shurjoint**.
- **For one time field test only** the maximum joint working pressure may be increased 1½ times the figures shown.
- **Warning:** Piping systems must always be depressurized and drained before attempting disassembly and or removal of any components.
- **Shurjoint** reserves the right to change specifications, designs and or standard equipment without notice and without incurring any obligations.

Job Name:	System No.	Location:	
Contractor:	Approved:	Date:	
Engineer:	Approved:	Date:	

Shurjoint product specifications in U.S. customary units and metric are approximate and are provided for reference only. For precise measurements, please contact **Shurjoint** Technical Service. **Shurjoint** reserves the right to change or modify product design, construction, specifications, or materials without prior notice and without incurring any obligations to make such changes and modifications on **Shurjoint** products previously subsequently sold.