

MODEL XH-1000 EXTRA HEAVY RIGID COUPLING

The **Shurjoint** Model XH-1000 is an extra heavy rigid coupling designed for high pressure services up to 1000 psi (70 bar), supplied with a standard C-shaped gasket and heavy duty bolts and nuts. The coupling is painted in green color. The Model XH-1000 can be installed on standard roll- or standard cut-grooved pipes. For sizes 2" through 4", there will be a gap between the bolt pads after installed and bolts and nuts shall be always tightened with a torque 60 – 70 Ft-Lbs (80-95 N-m). For sizes 6" and above, the bolt pads make a metal-to-metal contact when properly installed and there is no torque wrench requirement. The Model XH-1000 can be also used for stainless steel pipe.



Pressure-Temperature Rating

Size mm / in	Nom. Rating	Working Pressure (STD, Roll-Grooved)	Max. Service Temperature
2" – 6" 50 - 150	Class 400	1000 psi @100°F 70 Bar @38°C	EPDM: 230°F / 110°C Nitrile: 180°F / 82°C
8" – 12" 200 - 300	Class 300	750 psi @100°F 52 Bar @38°C	

*Working pressure is based on roll- or cut-grooved standard wall carbon steel pipe.

*Proof test pressure: 1.5 times the working pressure, non-shock cold water.

*Burst pressure is engineered minimum 3 times the working pressure.

MODEL XH-1000 EXTRA HEAVY RIGID COUPLING

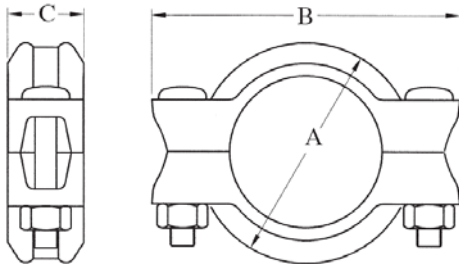

Model XH-1000 Extra Heavy Rigid Coupling

Nominal Size	Pipe OD	Max. Working Pressure	Max. End Load	Axial Displace- ment	Dimensions			Bolt / Nut No.	Bolt / Nut Size	Weight
					A	B	C			
mm in	mm in	Bar PSI	kN Lbs	mm in	mm in	mm in	mm in		in	Kgs Lbs
50 2	60.3 2.375	70 1000	20.0 443.0	0 - 3.6 0 - 0.14	90 3.50	150 5.90	49 1.92	2	5/8 x 2 3/4	1.8 3.4
65 2 1/2	73.0 2.875	70 1000	29.3 6490	0 - 3.6 0 - 0.14	102 4.02	168 6.62	49 1.92	2	5/8 x 2 3/4	1.7 3.8
80 3	88.9 3.500	70 1000	43.4 9620	0 - 3.6 0 - 0.14	123 4.86	188 7.38	49 1.92	2	5/8 x 2 3/4	2.2 4.8
100 4	114.3 4.500	70 1000	71.8 15900	0 - 6.4 0 - 0.25	155 6.09	222 8.74	53 2.10	2	3/4 x 4 3/4	3.8 8.4
150 6	168.3 6.625	70 1000	155.6 34450	0 - 6.4 0 - 0.25	218 8.58	295 11.61	57 2.25	2	7/8 x 5 1/8	8.0 17.6
200 8	219.1 8.625	52 750	196.0 43800	0 - 6.4 0 - 0.25	275 10.83	364 14.33	70 2.75	2	1 x 5 1/2	10.9 24.0
250 10	273.0 10.750	52 750	304.2 68040	0 - 6.4 0 - 0.25	334 13.15	424 16.70	75 2.95	2	1 x 5 1/2	14.2 31.2
300 12	323.9 12.750	52 750	428.2 95710	0 - 6.4 0 - 0.25	390 15.35	480 18.90	75 2.95	2	1 x 5 1/2	16.7 36.7



Sizes 2" through 4" require a bolt torque of 60 – 70 Ft-Lbs (80 – 95 N-m). Normally you can see some gaps between the bolt pads. Bolt pad gaps should be equal on both sides of the coupling.



Sizes 6" through 12" are designed to make a metal-to-metal contact when properly installed.

MATERIAL SPECIFICATIONS

- **Housing:**

Ductile Iron to ASTM A536, Gr. 65-45-12 and or ASTM A395 Gr. 65-45-15, min. tensile strength 448Mpa (65,000 psi).

- **Surface Finish:**

Green painted.

- **Rubber Gasket:**

Grade "T" Nitrile C-shaped standard gasket (Color code: Orange stripe). Recommended for petroleum products, air with oil vapors, vegetable and mineral oils within the specified temperature range. Also good for water services under +66°C (+150°F).
 Temperature range: -29 °C to +82 °C (-20 °F to +180 °F).

Do not use for HOT WATER above +66 °C (+150 °F) or HOT DRY AIR above +60 °C (+140 °F)

- Other options: Grade "E" – EPDM.
 Grade "O" - Fluoroelastomer.
 Grade "L" - Silicone.

For additional details contact *Shurjoint*.

- **Bolts & Nuts:**

Heat treated carbon manganese steel track bolts to ASTM A449-83a (or A183 Gr. 2), minimum tensile strength 758 MPa (110,000 psi), Zinc electroplated, with heavy-duty hexagonal nuts to ASTM A563.

General Notes:

- Pressure ratings listed are CWP (cold water pressure) or maximum working pressure within the service temperature range of the gasket used in the coupling. For additional information contact *Shurjoint*.
- Maximum working pressures and end loads listed are total of internal and external pressures and loads based on Sch. 40 steel pipe with roll grooves to ANSI/AWWA C606-07 specifications. For information on other pipe schedules contact *Shurjoint*.
- **For one time field test only** the maximum joint working pressure may be increased 1-1/2 times the figures shown.
- **Warning:** Piping systems must always be depressurized and drained before attempting disassembly and or removal of any components.
- *Shurjoint* reserves the right to change specifications, designs and or standard equipment without notice and without incurring any obligations.

Job Name:	System No.	Location:
Contractor:	Approved:	Date:
Engineer:	Approved:	Date:

Shurjoint product specifications in U.S. customary units and metric are approximate and are provided for reference only. For precise measurements, please contact *Shurjoint* Technical Service. *Shurjoint* reserves the right to change or modify product design, construction, specifications, or materials without prior notice and without incurring any obligations to make such changes and modifications on *Shurjoint* products previously subsequently sold.